



Facilities Management  
Capital Construction & Renovations

Leake Building | 1450 Leake Drive  
P.O. Box 400726, Charlottesville, VA 22904-4726  
(434) 982-4621 | Fax (434) 982-4628  
[www.fm.virginia.edu](http://www.fm.virginia.edu)

Date: 05/27/2025

Alert No. 1

## NON-UVA PROJECT

### CONSTRUCTION ALERT

## VERVE

June 9 – August 1

**Please note:** The Verve is a residential development consisting of 1,332 beds across 463 units, with layouts ranging from studios to four-bedroom apartments. The project was developed by Subtext, with construction managed by John Moriarty and Associates (JMA). While this is not a UVA project, it is located near UVA Grounds. Due to its proximity, UVA is actively coordinating with the City of Charlottesville and the Verve project team to ensure clear communication and alignment on road and sidewalk detours.

### ITEMS OF INTEREST:

#### ROAD CLOSURE - Emmet St.

##### **Vehicles:**

Beginning Monday, June 9<sup>th</sup>, through August 1st, the intersection of Jefferson Park Ave (JPA) and Emmet St., continuing to Stadium Rd., will be closed to all vehicular traffic for day and night work 24 hours a day, seven days a week. See map.

**Pedestrians:** The current pathways on Stadium Rd., Emmet St. and JPA will remain in place and open during the road closure. See map.

**PHOTOS/MAPS OF AREAS AFFECTED:**

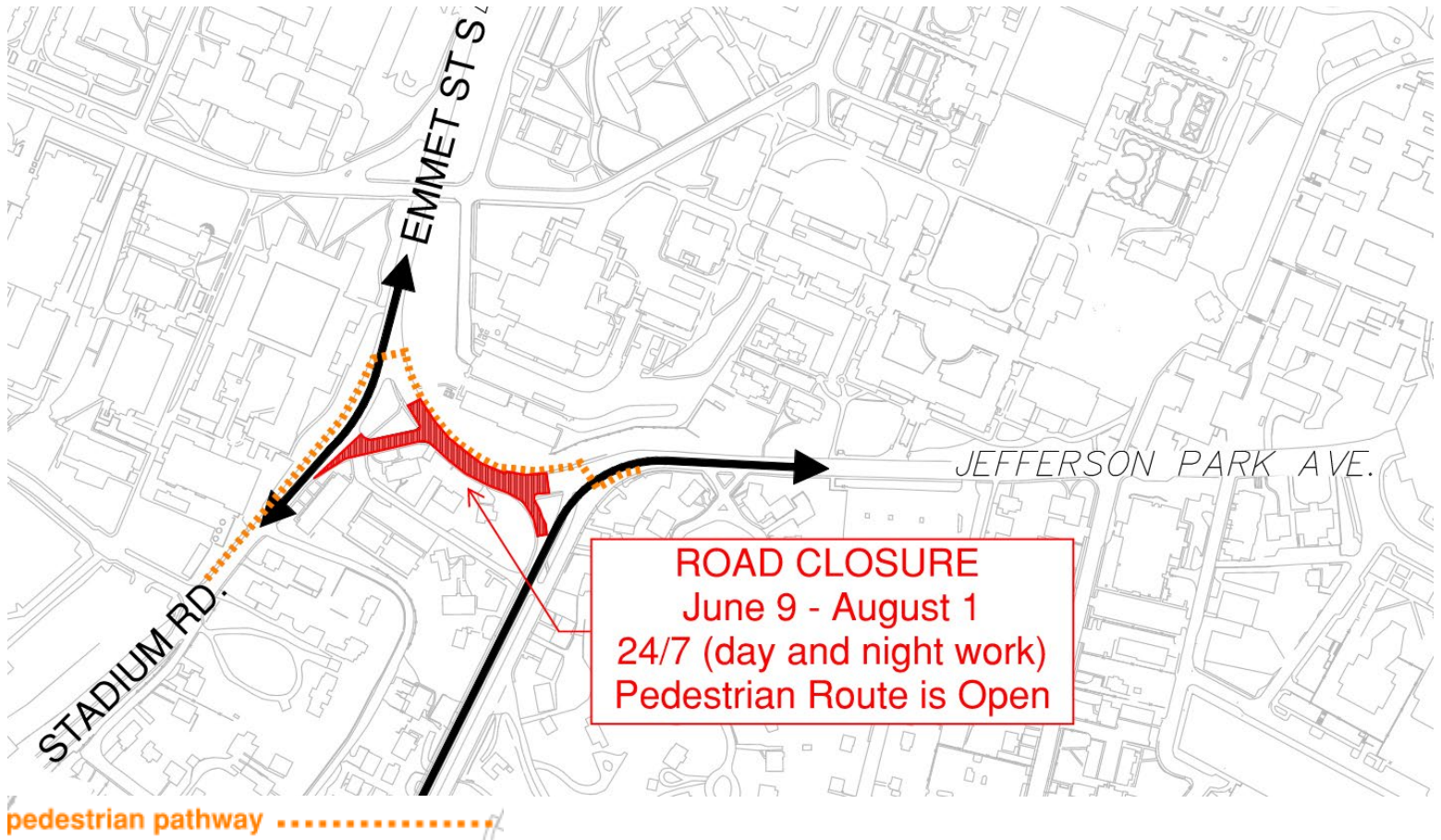

continue

**PHOTOS/MAPS OF AREAS AFFECTED:**

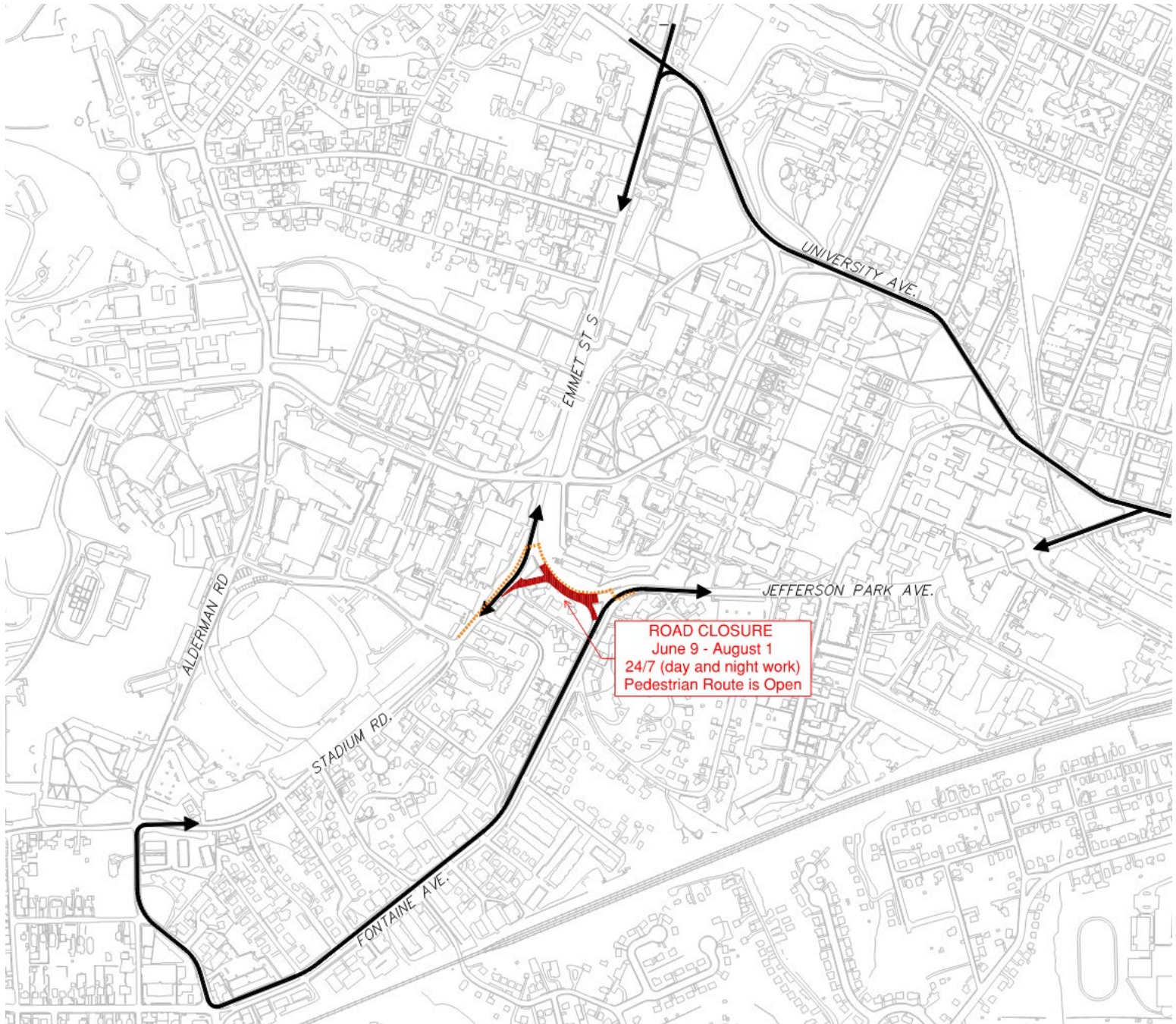

ISSUED BY:

- Chris Hoy - Senior Supervisory Construction Administration  
UVA FM CC&R, [cjh6t@virginia.edu](mailto:cjh6t@virginia.edu) 434.962.5326
- Megan Buschi - Senior Project Coordinator  
UVA FM CC&R, [jsg5fr@virginia.edu](mailto:jsg5fr@virginia.edu) 434.400.8594