

Date: 07/28/2022

Alert No. 051

## CONSTRUCTION ALERT

### Emmet-Ivy Corridor Public Realm Project Saturday, July 30<sup>th</sup> - Friday, August 5<sup>th</sup>

#### WHAT'S THE LATEST CHANGE?

Vehicles: The only entrance to the garage is from Ivy Rd. The Emmet St. is closed through Sunday, August 14<sup>th</sup>. For more information regarding the Emmet-Ivy Corridor Bridge sequence plan click here: <https://www.fm.virginia.edu/depts/fpc/projects/active/ivy-corridor/index.html> and then click construction alerts and resources for information through September 6<sup>th</sup>.

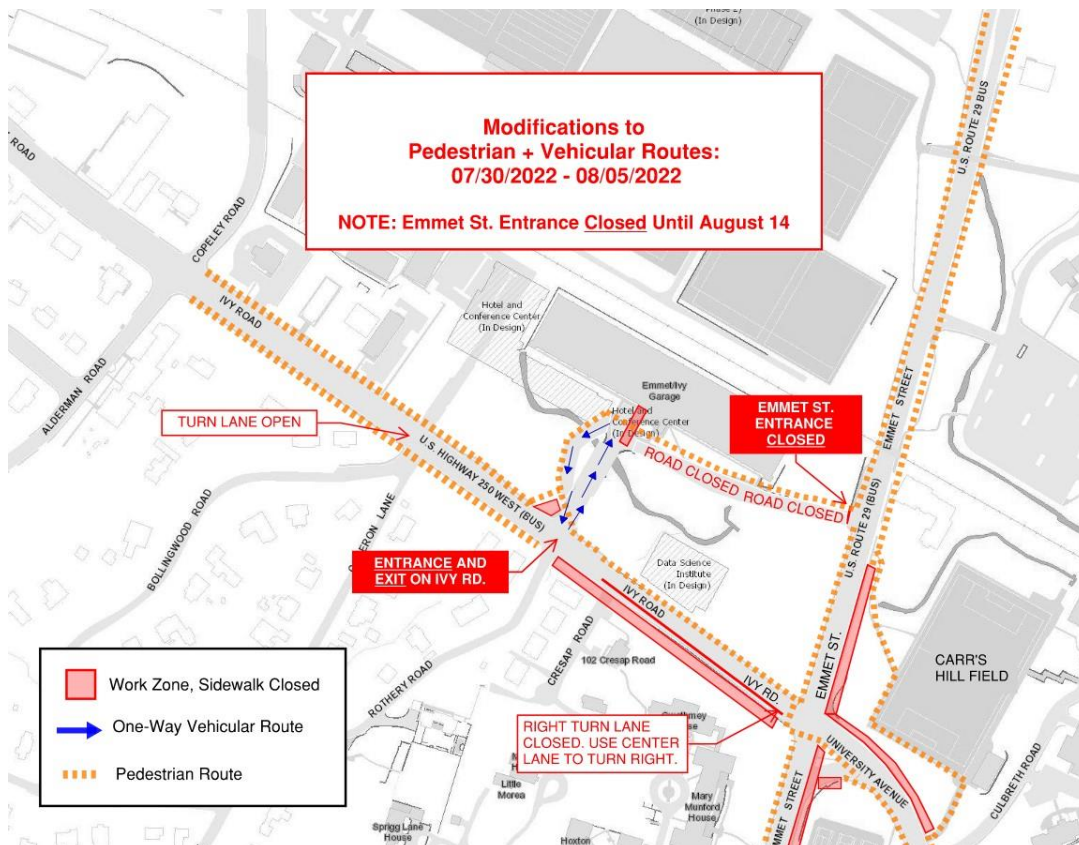

### **VEHICLES:**

- **Vehicles:** The southbound turning lane on Ivy Rd. is closed (day and night). Use the center lane to turn right onto Emmet St.
- **Vehicles:** The right turning lane on University Ave. to Emmet St. northbound is modified but remains open.
- **Vehicles:** The only entrance and exit to the Emmet-Ivy Garage is from Ivy Rd.

### **PEDESTRIANS**

- **Pedestrians:** The sidewalk along the south side of Ivy Rd. is closed and the north side is open. The sidewalk along the north side of Ivy Rd. from Copley Rd to the Blue Line bus stop is open. Follow the pedestrian route to continue eastbound on the north side of Ivy Rd. sidewalk.
- **Pedestrians:** the sidewalk along the north side of University Ave. from the Emmet-Ivy intersection to the Carr's Hill Field access road is closed. The sidewalk on the south side of University Ave is open.
- **Pedestrians:** The pedestrian route from Emmet-Ivy Garage to Central Grounds is to take the new road (around the bridge) to Ivy Rd. or Rothery Rd. to Emmet St. and University Ave.
- **Pedestrians:** The pedestrian route from Emmet/Ivy Garage to Lambeth/JPJ/Barracks Rd. takes Rothery Rd. to the west side of Emmet St.
- **Pedestrians:** The pedestrian route from Lambeth to Central Grounds is to take the sidewalk along the east side of Emmet St. and around the Carr's Hill Field path to University Ave.

### **ISSUED BY:**

- Chris Hoy, Construction Administration Manager - UVA FM CC&R, [cjh6t@virginia.edu](mailto:cjh6t@virginia.edu) , 434.962.5326
- Nat Perkins, Project Manager - UVA Foundation, [nperkins@uvafoundation.com](mailto:nperkins@uvafoundation.com) , 434.531.7387
- David Sellars, Construction Administration Manager – UVA FM CC&R, [des7n@virginia.edu](mailto:des7n@virginia.edu), 434.962.2935
- Megan Buschi - Project Coordinator - UVA FM CC&R, [jsg5fr@virginia.edu](mailto:jsg5fr@virginia.edu) 434.400.8594

### **BACKGROUND:**

- This project provides civil and utility infrastructure to support the development of Phase 1 of the new Ivy Corridor District. The first two buildings to be built within the district are the School of Data Science and the UVA Hotel and Conference Center.

END OF ALERT