

Date: 04/28/2022

Alert No. 037

CONSTRUCTION ALERT

Emmet-Ivy Corridor Public Realm Project Saturday, April 30th – Friday, May 6th

WHAT'S DIFFERENT THIS WEEK?

- The right turn lane on University Ave. is modified but remains open.



ITEMS OF INTEREST:

- Vehicles: The only entrance to the Emmet-Ivy Garage is from Emmet St. The only exit is onto Ivy Rd.
- Pedestrians: The sidewalk on the east and west side of Emmet St. is open.
- Pedestrians: The sidewalk along the south side of Ivy Rd. is closed. The north side of Ivy Rd. is open.
- Pedestrians: the sidewalk along the north side of University Ave. from the Emmet-Ivy intersection to the Carr's Hill Field is closed. The sidewalk on the south side of University Ave is open.

- Pedestrians: The pedestrian routes from Emmet-Ivy Garage to Central Grounds is to take the new road (around the bridge) to Ivy Rd. or Rothery Rd. to Emmet St.
- The pedestrian route from Emmet/Ivy Garage to Lambeth/JPJ/Barracks Rd. takes Rothery Rd. to the west side of Emmet St.
- Bus Stops: The Blue Line will serve EIG from Ivy Rd. The Gold and Silver Line will serve EIG from Emmet St.

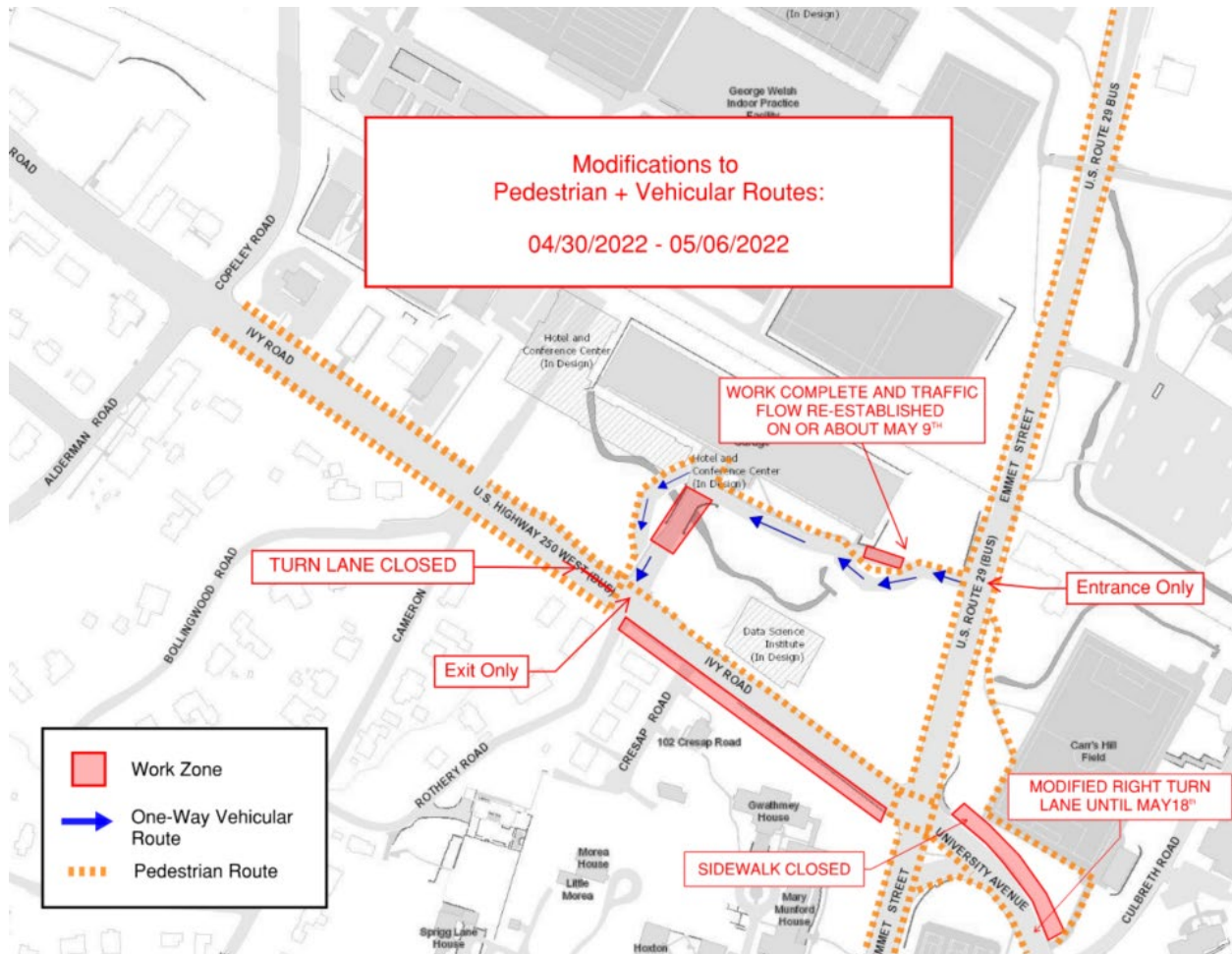

ISSUED BY:

- Chris Hoy, Construction Administration Manager - UVA FM CC&R, cjh6t@virginia.edu , 434.962.5326
- Nat Perkins, Project Manager - UVA Foundation, nperkins@uvafoundation.com , 434.531.7387
- Megan Buschi - Project Coordinator - UVA FM CC&R, jsg5fr@virginia.edu 434.400.8594

BACKGROUND:

- This project provides civil and utility infrastructure to support the development of Phase 1 of the new Ivy Corridor District. The first two buildings to be built within the district are the School of Data Science and the UVA Hotel and Conference Center.

END OF ALERT