

Date: 03/24/2022

Alert No. 032

CONSTRUCTION ALERT

Emmet-Ivy Corridor Public Realm Project Saturday, March 26th – Friday, April 1st

ITEMS OF INTEREST:

- Vehicles: The only entrance to the Emmet-Ivy Garage is from Emmet St. The only exit is onto Ivy Rd.
- Vehicles: The Ivy Rd. eastbound middle lane, used as a turning lane, is closed. The entrance to the EIG is on Emmet St.
- Bus Stops: The Blue Line will serve EIG from Ivy Rd. The Gold and Silver Line will serve EIG from Emmet St.
- Pedestrians: The sidewalk and bike lane closures continue along the north side of Ivy Rd. for utility work through the second quarter of 2022.
- Pedestrians: The sidewalk on the west side of Emmet St. is closed from Rothery Rd. to the Emmet-Ivy intersection. The sidewalk is scheduled to reopen this week. The east side of the Emmet St. sidewalk is open.
- Pedestrians: The pedestrian route from Emmet-Ivy Garage to Central Grounds is to take Rothery Rd. to the south side of Ivy Rd. The pedestrian route from Emmet/Ivy Garage to Lambeth/JPJ/Barracks Rd. takes Rothery Rd. to the west side of Emmet St.

BACKGROUND:

- This project provides civil and utility infrastructure to support the development of Phase 1 of the new Ivy Corridor District. The first two buildings to be built within the district are the School of Data Science and the UVA Hotel and Conference Center.

ISSUED BY:

- Chris Hoy, Construction Administration Manager - UVA FM CC&R, cjh6t@virginia.edu , 434.962.5326
- Nat Perkins, Project Manager - UVA Foundation, nperkins@uvafoundation.com , 434.531.7387
- Megan Buschi - Project Coordinator - UVA FM CC&R, jsg5fr@virginia.edu 434.400.8594

PHOTOS/MAPS OF AREAS AFFECTED:

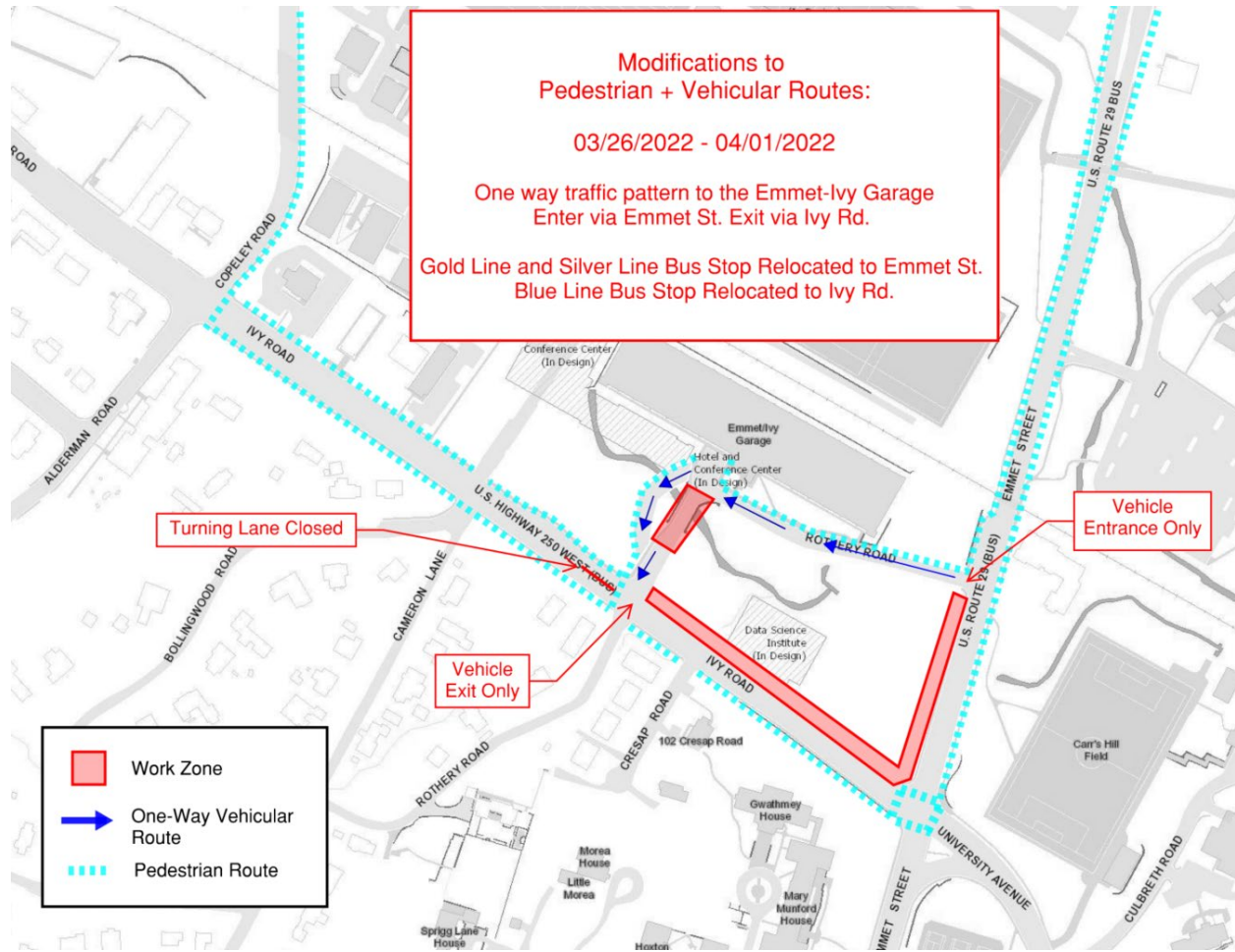

END OF ALERT