



Date: 01/13/2022

Alert No. 022

CONSTRUCTION ALERT Emmet-Ivy Corridor Public Realm Project

ITEMS OF INTEREST:

- Faulconer Construction Co. will continue sidewalk and bike lane closures along the north side of Ivy Rd. for utility work from Saturday, January 15th through Friday, January 21st.
- Traffic will remain open in all directions on Ivy Rd. and Emmet St., both day and night. Signage for the impacts will be coordinated with the City of Charlottesville.
- Pedestrian route from Emmet/Ivy Garage to Central Grounds is to take Rothery Rd. to the south side of Ivy Rd. Pedestrian route from Emmet/Ivy Garage to Lambeth/JPJ/Barracks Rd. is to take Rothery Rd. to the west side of Emmet St.
- Pedestrian traffic is closed along the north side of Ivy Rd. The sidewalk on the east side of Emmet St. is now open to pedestrian traffic.

BACKGROUND:

- This project provides civil and utility infrastructure to support the development of Phase 1 of the new Ivy Corridor District. The first two buildings to be built within the district are the School of Data Science and the UVA Hotel and Conference Center.

ISSUED BY:

- Chris Hoy, Construction Administration Manager – UVA FM CC&R, cjh6t@virginia.edu , 434.962.5326
- Nat Perkins, Project Manager - UVA Foundation, nperkins@uvafoundation.com , 434.531.7387
- Megan Buschi - Project Coordinator UVA FM CC&R, jsg5fr@virginia.edu 434.400.8594

PHOTOS/MAPS OF AREAS AFFECTED:

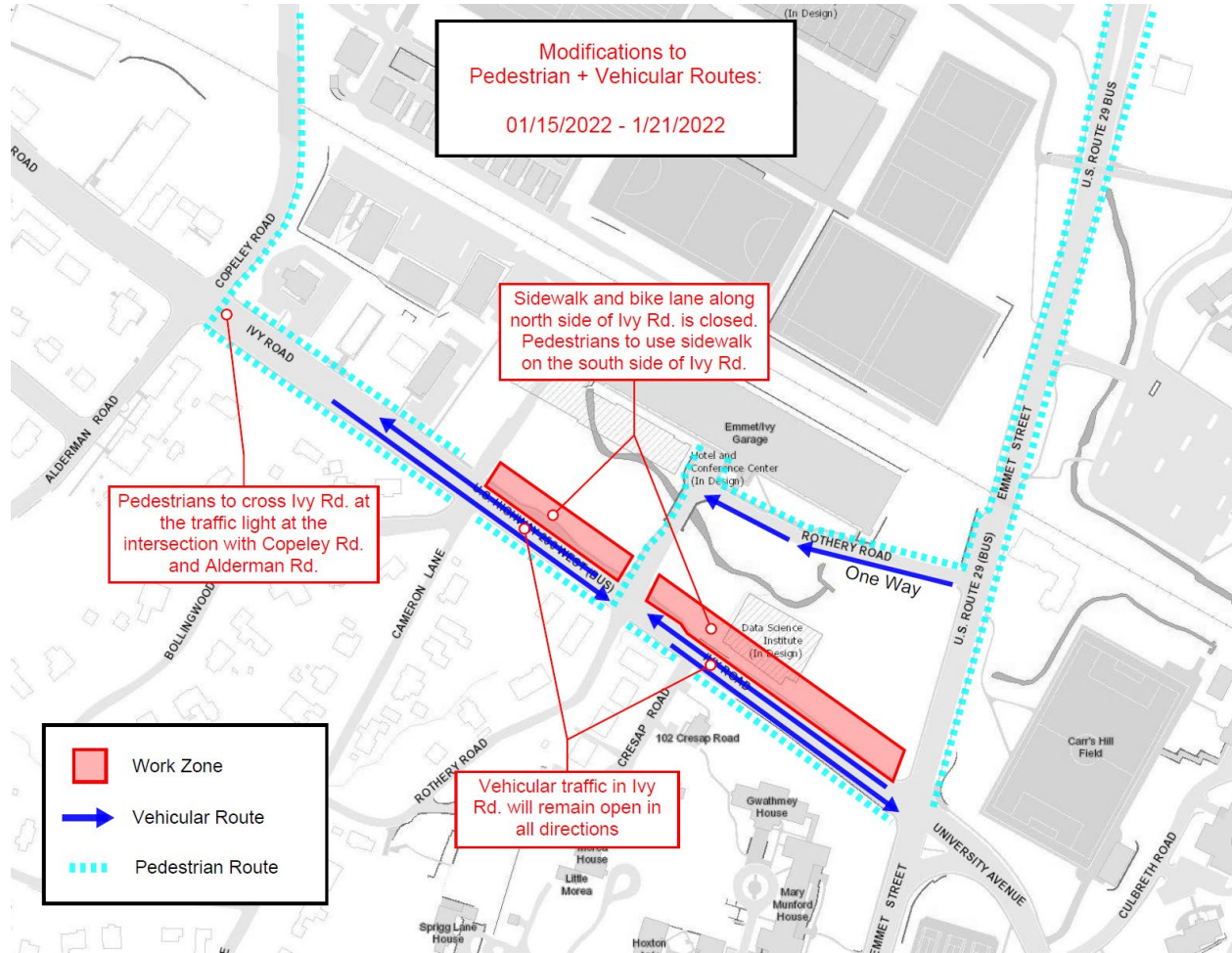

END OF ALERT