

Date: 07/19/2022

CONSTRUCTION WORK NOTIFICATION

Hello, Emmet-Ivy Garage (EIG) commuters!

Starting Monday, July 25th, the Faulconer construction team will pour concrete at the entrance and exit lanes to the garage. When entering and exiting the garage, please use caution and follow the construction signs. We appreciate your reduced speeds. The pedestrian routes will change frequently but not increase in length. To keep traffic flowing smoothly and quickly, we have a sequencing plan to mitigate any disruption to your morning and evening commute.

July 25th – August 14th Garage entrance on Ivy Rd.

The Emmet St. entrance will be closed from Monday, July 25th until Sunday, August 14th, 2022.

Vehicles will enter the EIG from Ivy Rd. and drive across the new bridge into the garage. The lanes entering and exiting the garage will be reduced to one lane each. Exiting vehicular traffic will follow the existing temporary road around the bridge to Ivy Rd.

Pedestrians seeking the Blue Line bus stop are encouraged to exit the garage via the elevator tower and use the crosswalk to the temporary path around the bridge to the Blue Line bus stop. The Gold/Silver Line riders follow the sidewalk to the west side of Emmet St. Pedestrians headed to central grounds have full access to the sidewalks around the Ivy Corridor.

NOTE: The Ivy Rd. eastbound turning lane into the garage is OPEN.

August 15th – September 5th Garage entrance on Emmet St.

The Emmet St. entrance will open (and the Ivy Rd. entrance will be closed) Monday, August 15th, until Monday, September 5th, 2022.

Vehicles will enter the EIG from Emmet St., and exiting traffic will drive across the new bridge to Ivy Rd. (The temporary bypass road will be removed.)

Pedestrians will follow the new route across the bridge and connect to the temporary path to the Blue Line bus stop. The Gold/Silver Line riders follow the sidewalk to the west side of Emmet St. Pedestrians headed to central grounds have full access to the sidewalks around the Ivy Corridor.

NOTE: The Ivy Rd. eastbound turning lane into the garage is CLOSED.

September 6th – Final Condition Garage entrance on Ivy Rd.

The permanent and final condition will be complete.

Vehicles will enter and exit the garage from Ivy Rd. The eastbound Ivy Rd. turning lane into the garage will be open. Exiting traffic will be controlled by a new signal arm and traffic lights.

Pedestrians will access the Blue Line bus stop by crossing the bridge and continuing onto the sidewalk along the north side of Ivy Rd. Gold/Silver line riders will follow the sidewalk to Emmet St.

Pedestrians headed to central grounds have full access to the sidewalks around the Ivy Corridor.

NOTE: The Ivy Rd. eastbound turning lane into the garage is OPEN.

Monday, July 25th – Sunday, August 14th
Garage Entrance on Ivy Rd.

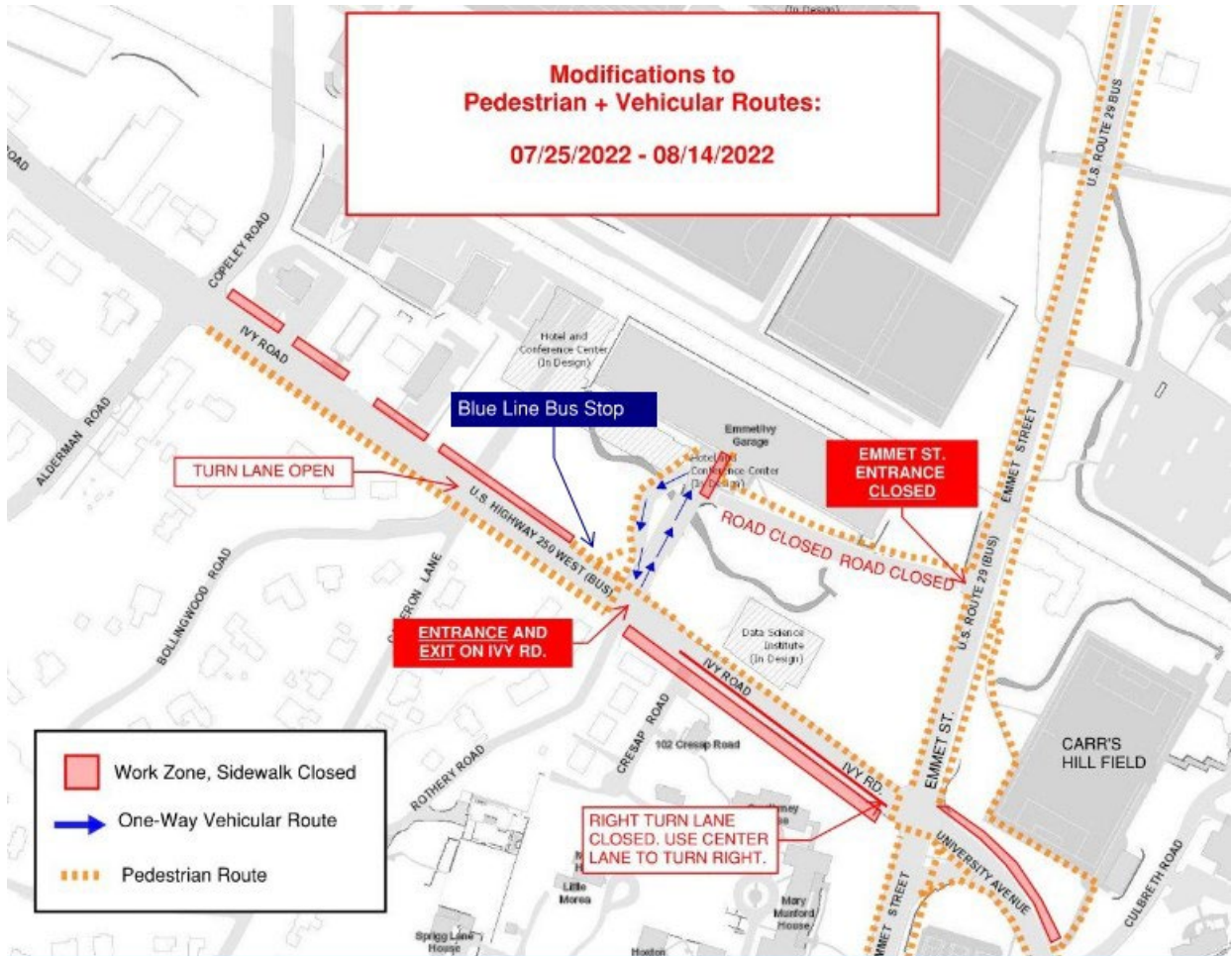

Monday, August 15th – Monday, September 5th
Garage Entrance on Emmet St.

