

Date: 10/28/2021

Alert No. 013 (revision 02)

CONSTRUCTION ALERT

Ivy Corridor – Public Realm Project

ITEMS OF INTEREST:

- Faulconer Construction Co will be closing Emmet St continuously for utility work in the road from Monday, November 1st through Friday, November 12th, 2021
- This will be a full closure of all lanes in Emmet St between Rothery Rd and Ivy Rd. This closure will start at 12:00am midnight morning of November 1st and will be 24hrs/day until the work is complete. Traffic will be diverted via a detour route taking Massie Rd/ Copeley Rd/ Ivy Rd. Only vehicular traffic for Lambeth Housing will be allowed southbound beyond Massie Rd and there will be a full closure of southbound lanes at the entrance to Lambeth Housing. Signage for the detour will be coordinated with the City of Charlottesville.
- All lanes of vehicular traffic in Emmet St in both directions will be open for the weekends of UVA home football games.
- Pedestrian traffic will be closed on both sides of Emmet St where work is taking place due to safety concerns regarding crane operation. Sidewalk is also closed along the North side of Ivy Rd. Pedestrian route from Emmet/Ivy Garage to Central Grounds is to take Rothery Rd to south side of Ivy Road. Pedestrian route from Emmet/Ivy Garage to Lambeth/JPJ/Barracks Rd is to take Rothery Rd to the west side of Emmet St.
- There will be a temporary crosswalk installed across Emmet St just south of the road closure at the Lambeth Housing vehicular entrance to facilitate pedestrian traffic from Lambeth to the Emmet/Ivy Garage.

BACKGROUND:

- This project provides civil and utility infrastructure to support the development of Phase 1 of the new Ivy Corridor District. The first two buildings to be built within the district are the School of Data Science and the UVA Hotel and Conference Center.

ISSUED BY:

- Chris Hoy, CAM – UVA FM CC&R, cjh6t@virginia.edu , 434.962.5326
- Nat Perkins, PM - UVA Foundation, nperkins@uvafoundation.com , 434.531.7387

PHOTOS/MAPS OF AREAS AFFECTED:

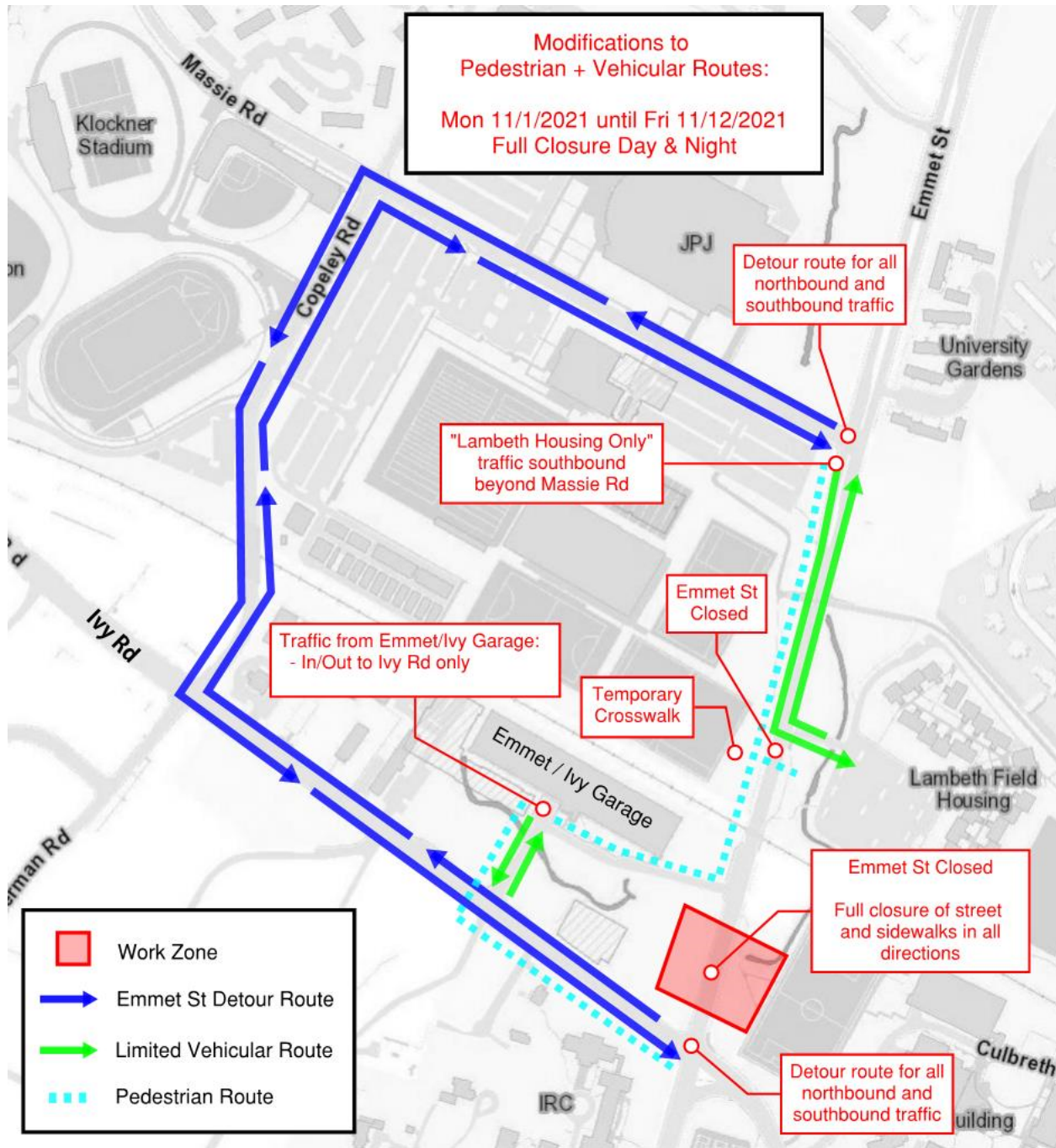

END OF ALERT