



Date: 12/08/2023

Alert No. 082

## **CONSTRUCTION ALERT**

### Emmet-Ivy Corridor Public Realm Project Monday, December 18<sup>th</sup> – Friday, December 22<sup>nd</sup>

#### **WHAT'S THE LATEST CHANGE?**

**Pedestrians:** A small portion of the sidewalk on the south side of Ivy Rd. and an island in Rothery Rd. south (same location) will be closed on Monday, December 18th. One lane of Rothery Rd. will be available for residents, and crosswalks on Ivy Rd. will be open. See map.

The sidewalk on the north side of Ivy Rd. from the Emmet-Ivy intersection (the north/west corner) to Rothery Rd. is closed and will reopen in January 2024.

**continue to map**

**Modifications to  
Pedestrian + Vehicular Routes:  
12/18/23 -12/22/23**

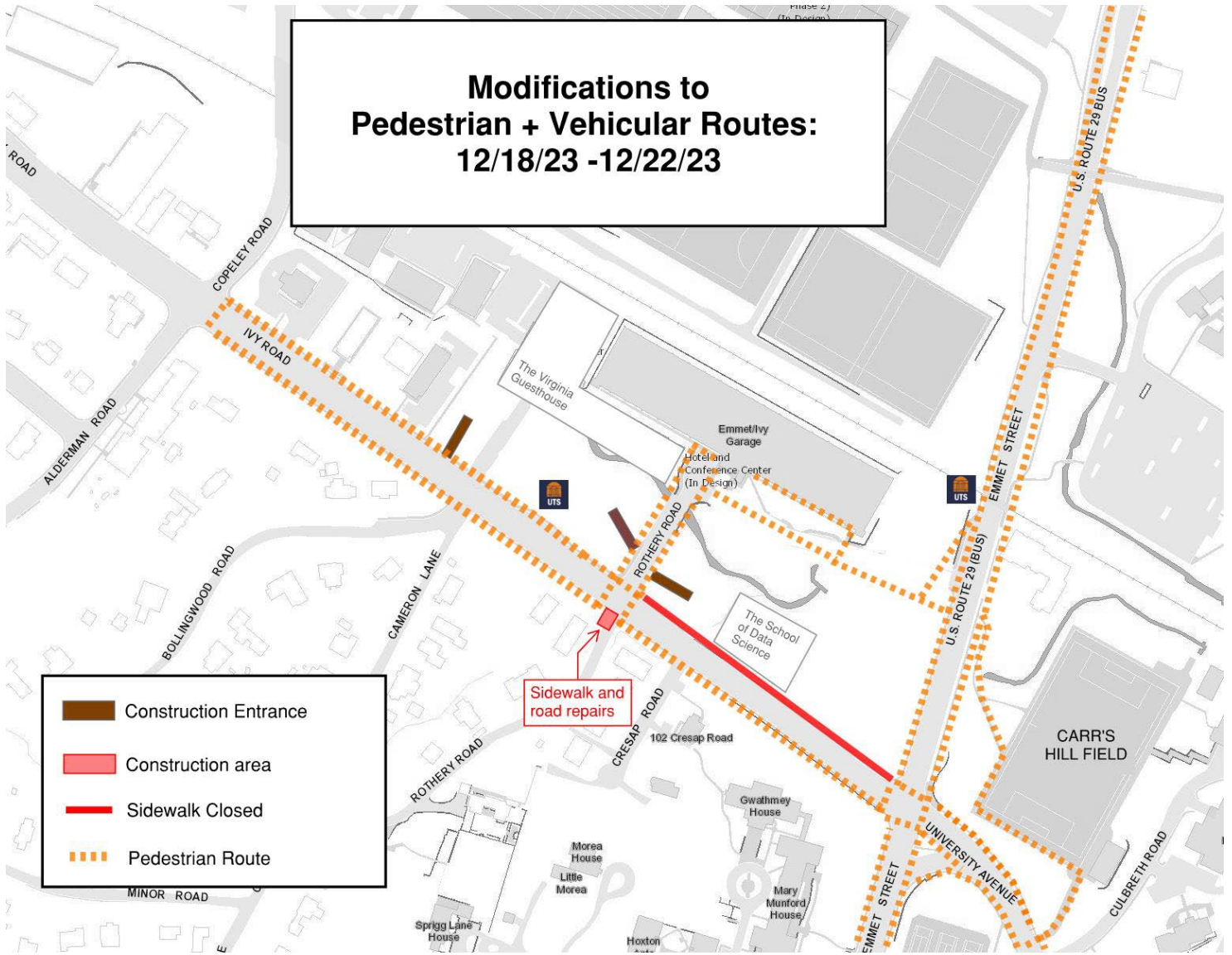

**ISSUED BY:**

- Chris Hoy, Construction Administration Manager  
UVA FM CC&R, [cjh6t@virginia.edu](mailto:cjh6t@virginia.edu) 434.962.5326
- Megan Buschi - Project Coordinator  
UVA FM CC&R, [jsg5fr@virginia.edu](mailto:jsg5fr@virginia.edu) 434.400.8594