

Date: 4/10/2023

Alert No. 075

CONSTRUCTION ALERT

Emmet-Ivy Corridor Public Realm Project Monday, April 10th – Friday, April 14th

WHAT'S THE LATEST CHANGE?

Vehicles: **NIGHT WORK 9pm-5am** Ivy Rd. east and westbound will experience lane modifications due to asphalt patching the week of April 10th. (Weather dependent)

Vehicles: **NIGHT WORK 9pm-5am** Emmet St. north and southbound will experience lane modifications due to asphalt patching the week of April 10th. (Weather dependent)

PEDESTRIANS:

- **Pedestrians:** A new construction entrance is created south of the Rothery Rd. bridge. Construction trucks and traffic will cross over the sidewalk into the site. Flaggers will be assisting with pedestrian and vehicular traffic.
- **Pedestrians:** The sidewalk along the south side of Ivy Rd. is closed.

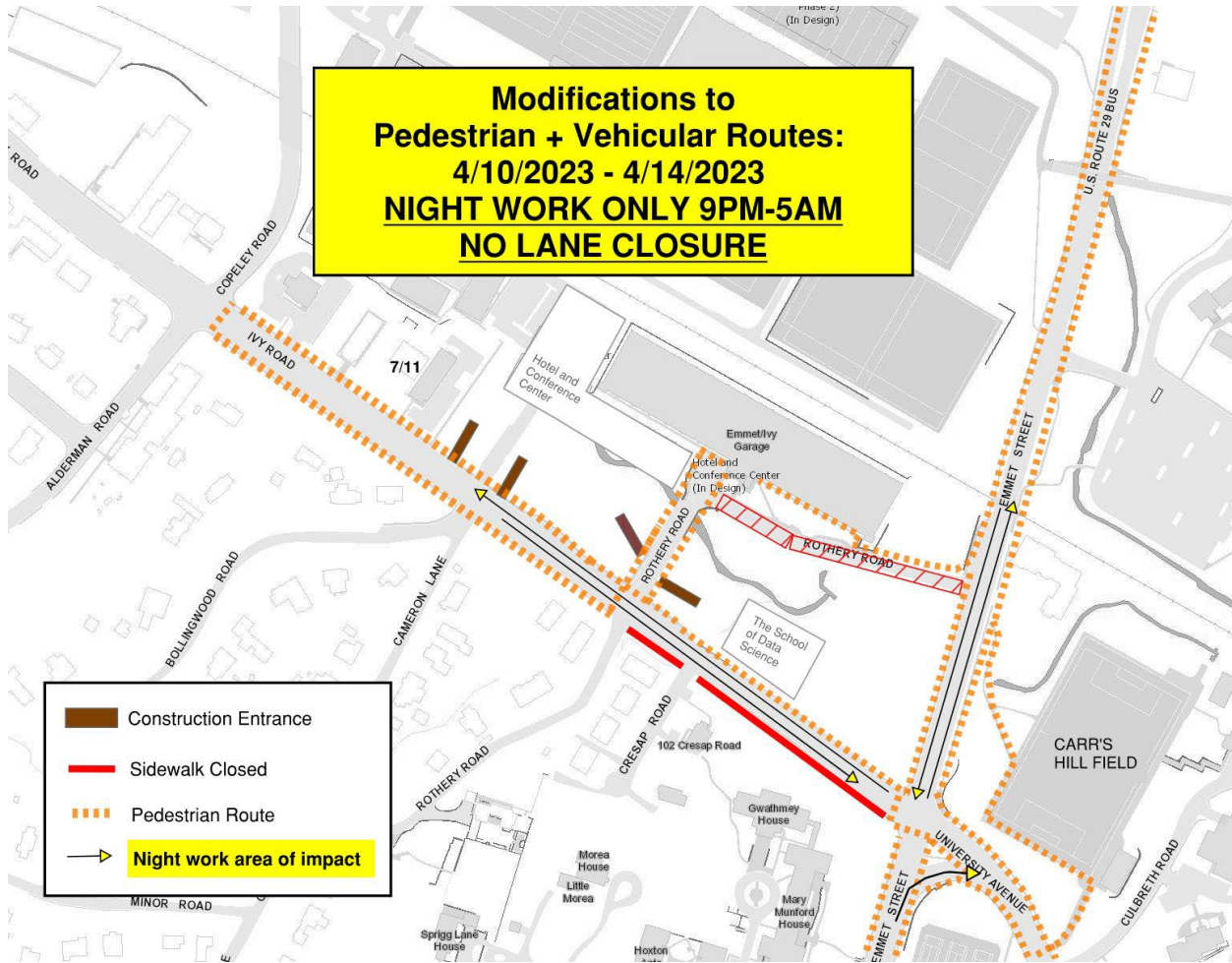

ISSUED BY:

- Chris Hoy, Construction Administration Manager -UVA FM CC&R, cjh6t@virginia.edu 434.962.5326
- Nat Perkins, Project Manager - UVA Foundation, nperkins@uvafoundation.com, 434.531.7387
- Megan Buschi - Project Coordinator - UVA FM CC&R, jsg5fr@virginia.edu 434.400.8594