

Date: 09/03/2022

Alert No. 056

CONSTRUCTION ALERT

Emmet-Ivy Corridor Public Realm Project
Saturday, September 3rd – Friday, September 9th

WHAT'S THE LATEST CHANGE?

- **Vehicles:** Starting Monday, August 29th the only entrance and exit to the garage is from Ivy Rd. The Emmet St. entrance is closed permanently.
- **Vehicles:** **Night Work (7pm-7am)** Tuesday, September 6th the Ivy Rd. westbound lane is modified but remains open.

PEDESTRIANS:

- **Pedestrians:** The routes around and on the Rothery Rd. bridge will be clearly marked but change frequently.
- **Pedestrians:** The sidewalk along the north side of Ivy Rd. is modified at the intersection of Rothery Rd and Ivy Rd. The crosswalk signal has been disabled temporarily.

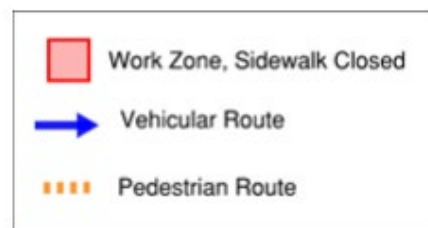

- Pedestrians:** The sidewalk along the south side of Ivy Rd. is closed and the north side is open. The sidewalk along the north side of Ivy Rd. from Copley Rd to the Blue Line bus stop is open. Follow the pedestrian route to continue eastbound on the north side of Ivy Rd. sidewalk.

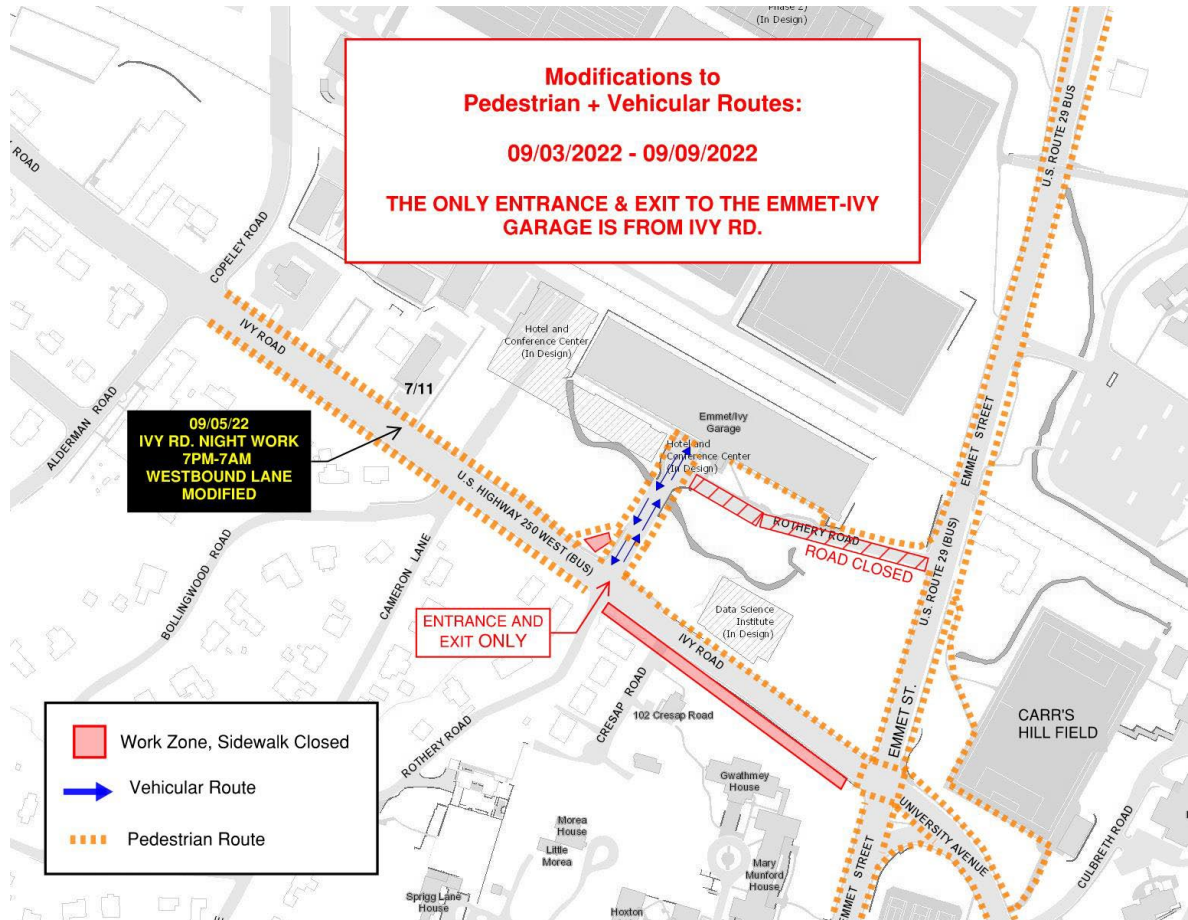

ISSUED BY:

- Chris Hoy, Construction Administration Manager -UVA FM CC&R, cjh6t@virginia.edu 434.962.5326
- Nat Perkins, Project Manager - UVA Foundation, nperkins@uvafoundation.com , 434.531.7387
- Megan Buschi - Project Coordinator - UVA FM CC&R, jsg5fr@virginia.edu 434.400.8594